

**Application:**

1. Thunder Series High Flow Pumps is great choice for spa lovers, it's suitable for hydro massage tub whirlpool / concrete Jacuzzi system for High flow.

**Motor:**

Air cooling motor is suitable for Europe. Design of winding is advanced and High technology in spa, Suitable for commercial spa / Jacuzzi, its new invention in Pumps industry. Frame and base is conjoined with material of aluminum. This pump is under low-noise and less-vibration and durability that are specialized for Whirlpool SPA / Jacuzzi and swimming pool pump.

- Insulation class F.
- Protection IP55.
- Continuous duty.
- Single-phase with thermal protector from T1 to ensure safety.
- Medium temperature 50°C.

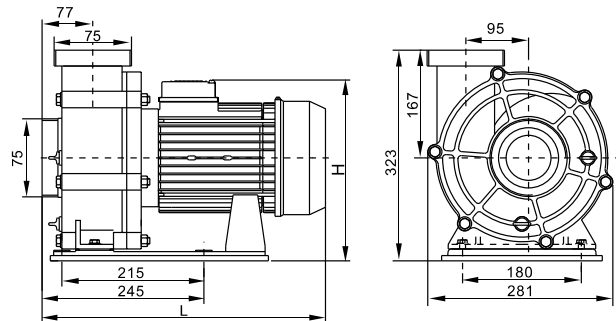
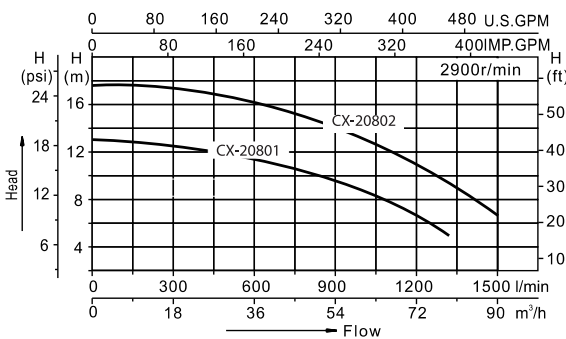
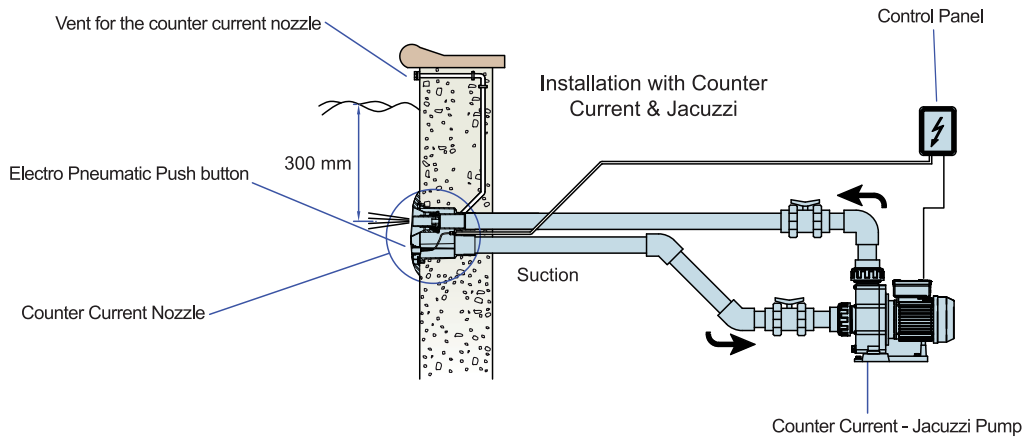

Model	Qmax (l/min)	Hmax (m)	Power (P1)		(Amps) 380V / 50Hz	Fitting Size (mm)	(Kg)	Packing size (mm)	(Qty/20')	Volumen Volume m
			kW	HP						
CX-20801	1300	13	3.0	4.0	5.2	3"	23.9	445x310x360	584	0,067
CX-20802	1500	17.5	4.0	5.5	7.0	3"	25.6	475x310x360	547	0,067